

DIRECTIONS TO ULYSSES

SR: LITRE LEAGUE FIELD

LOCATED RTE 49 EAST OF ULYSSES PA.

BEHIND NORTHERN POTTER HIGH SCHOOL

763 SR 49.

ULYSSES PA. 16948.

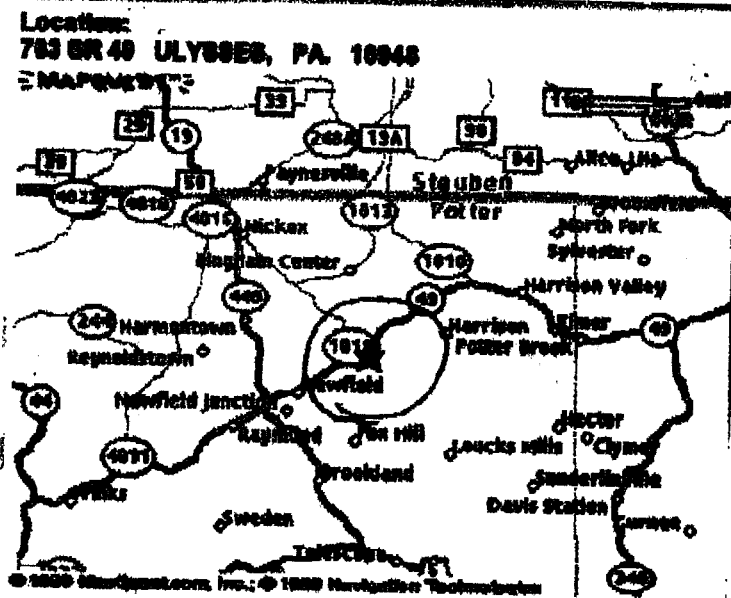

Galeton Little League Field (Major & minor) Baseball

From Wellsboro on Rt 6 West to Galeton, approx. 24 miles. Turn left at only Red light onto Bridge St. From Connersport on Rt 6 East to Galeton turn right at Red light onto Bridge St. Stay straight on Bridge St across bridge, stay to left. Follow road around sharp left turn by community bldg, and go up hill (Sherman St.) Take first or second right hand turns. (Orchard or Adams Sts) either will take you to field.

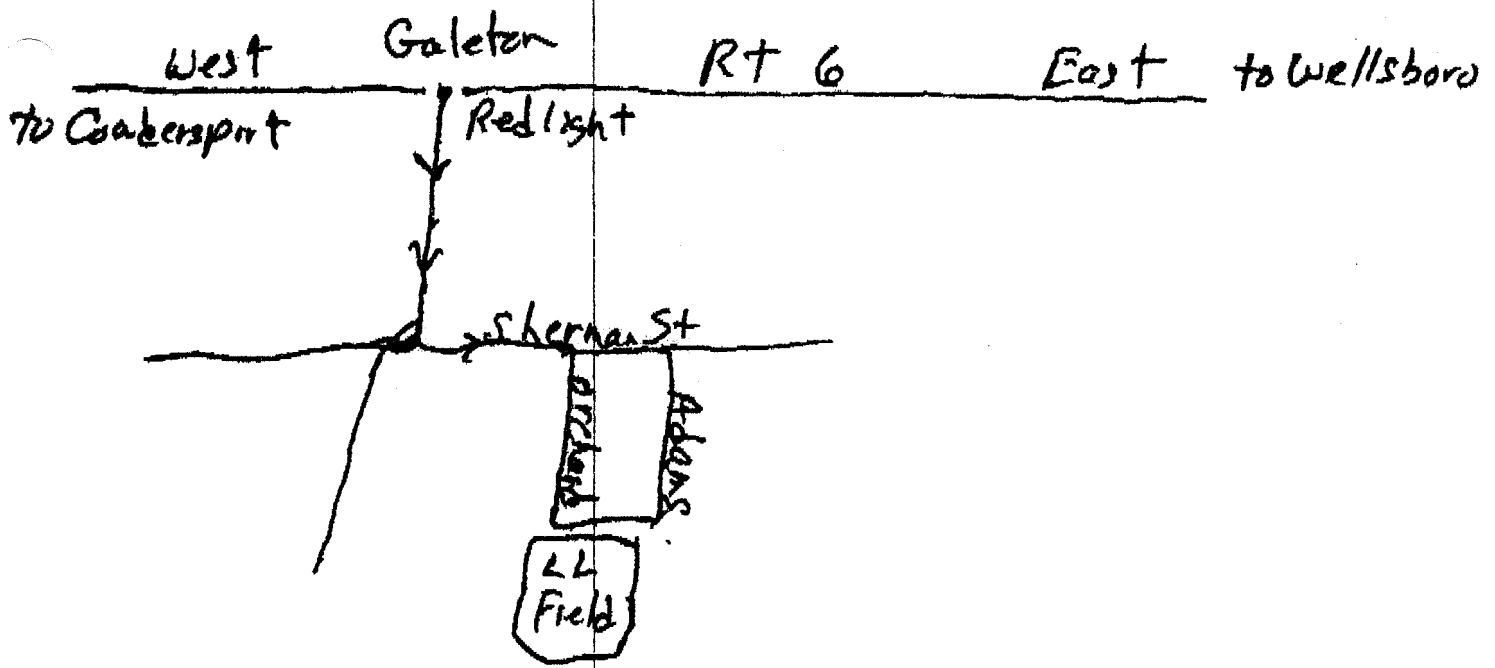

(not to scale)

Saletan Senior Little League Baseball Field

3

From Wellsboro on Rte. 6 West to Galetan, approx 24 miles, Turn left at only red light onto Bridge St. Take next left into the high school. Stay right - Field is behind school.
 Traveling East on 6 into Galetan - turn right at light & then next left

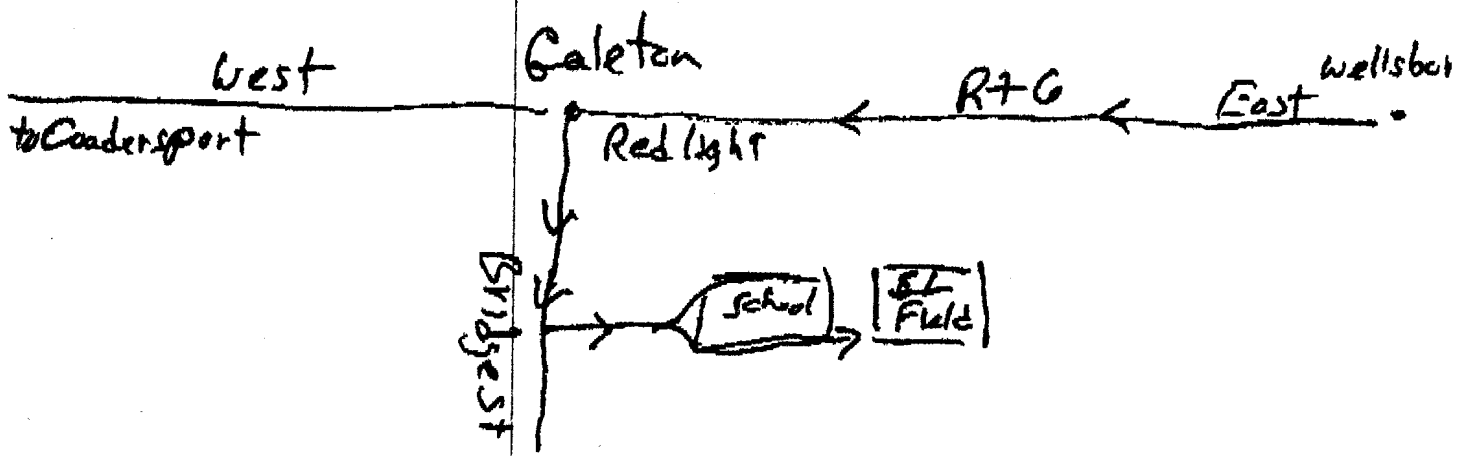

(not to scale)

(4)

Pruitt Field - Galeton Softball Field

Route 6 West from Wellsboro approx. 24 miles to Galeton. Just inside Galeton limits turn left onto Mill Street, go one block to stop sign, turn left onto Clinton St. Ext. Road will change to dirt (field is approx. 1/2 mile down dirt road). Turn right onto driveway to field which is several hundred yards up hill.

Pruitt Field

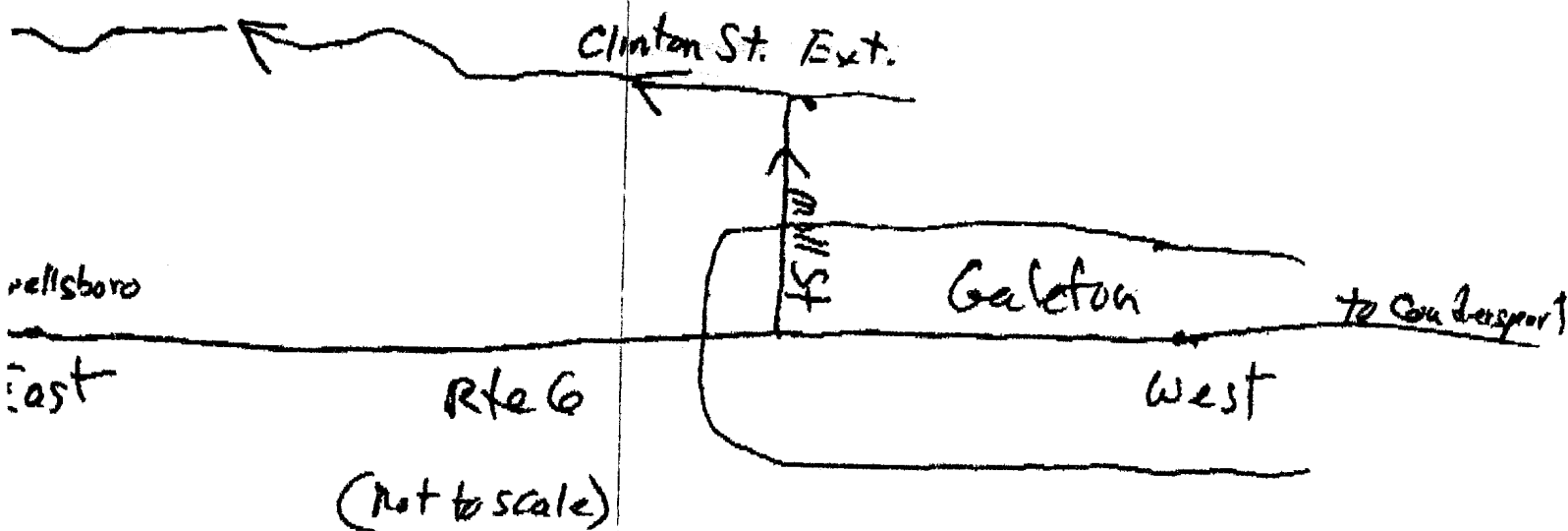

✓ Elkland Little League Field (major + minor) Baseball (5)

✓ Elkland Little League Softball field

✓ Elkland Senior Little League Field

From Rt 6 in Mansfield take 15 North to Lawrenceville. Turn left at light onto Rt 49 West to Elkland (approx. 12 miles). As you enter Elkland you will cross bridge. You can see LL Baseball Field #1, off to right from bridge. After bridge turn right by Chevrolet dealer. Proceed very short distance: Field #1 LL. Baseball on right, Softball & Senior LL Field are on left.

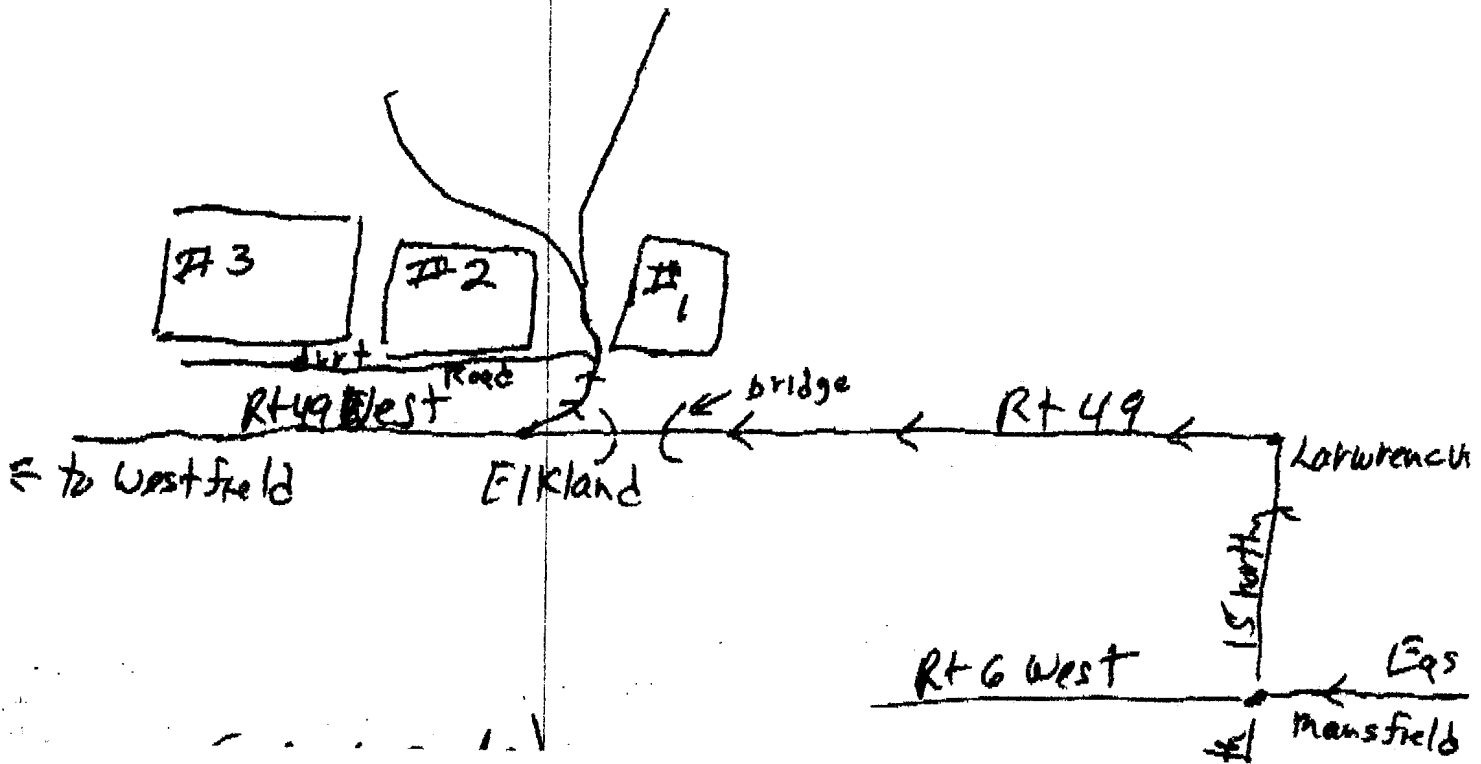

6

Knoxville Little League Field

From Rt 6 West in Mansfield, turn right onto
 15 North to Lawrenceville. At light in Lawrenceville
 turn left on to 49 West. Go through Elkland to
 Knoxville, approx. 8 miles. Going west on 49
 through this small community, as you approach
 western edge of town you will see a Furina
 mill ahead on right side. On left there is a
 small street without name sign that leads
 back to Field. They will place a Field
 sign along 49 + this road

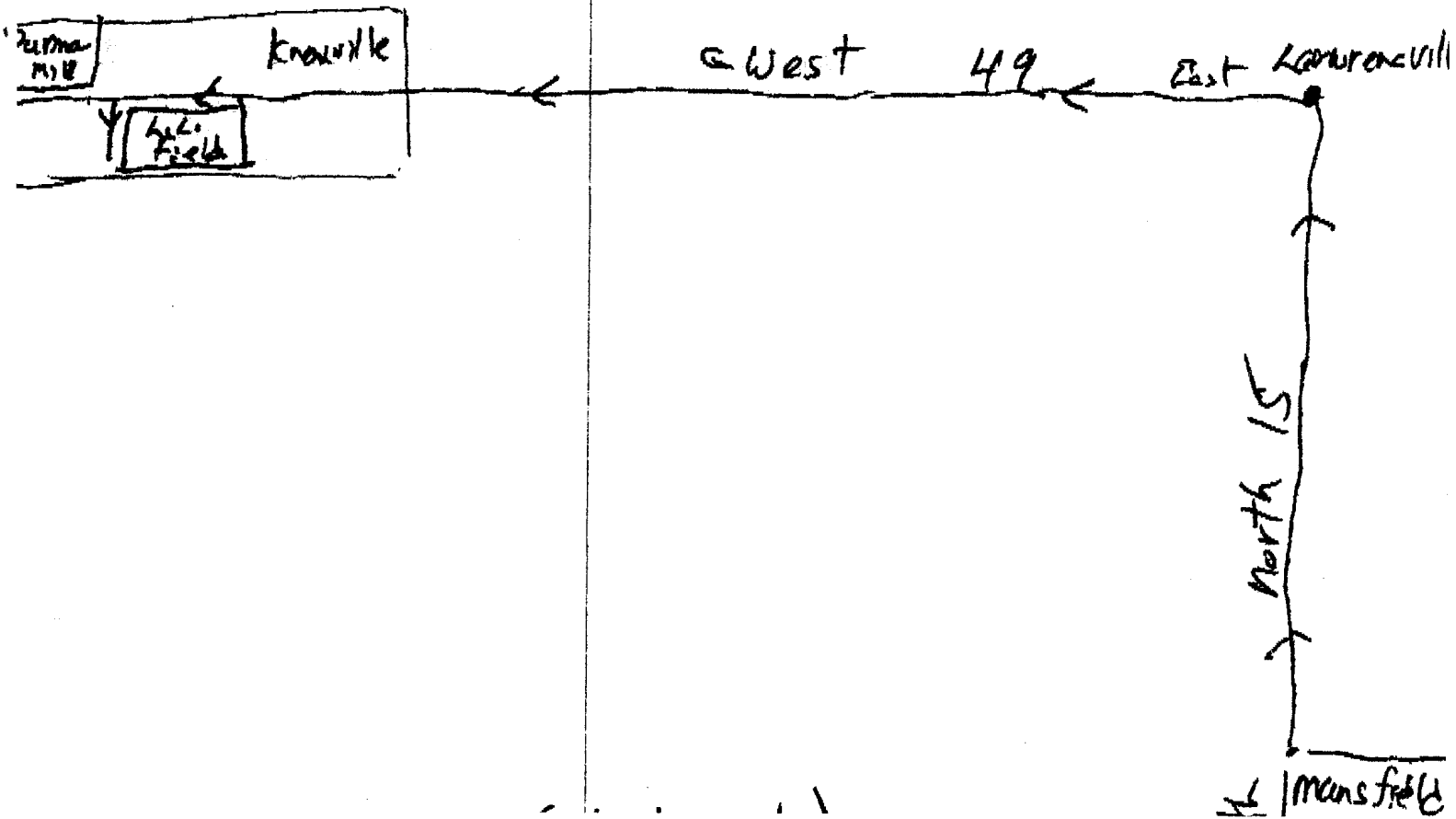

1/ Westfield Little League Soft Ball Field

2/ Westfield Senior Little League Baseball Field

3/ Westfield Little League Baseball Field (Major/Minor)

From RT6 West in Mansfield, Turn right onto 15 North to Lawrenceville. At light in Lawrenceville turn left on to RT49 West. Go through Elkland & Knoxville. As you enter Westfield you will see Harter's market on Right side + old brick School House on left, Field #1 - Softball is behind brick building on left. If you continue west on 49 you will see Municipal Bldg/Fire Hall on right and Walnut St. on left. Turn left on Walnut St. to dead end Field site. Senior LL Baseball + LL Baseball (major + minor) are located here.

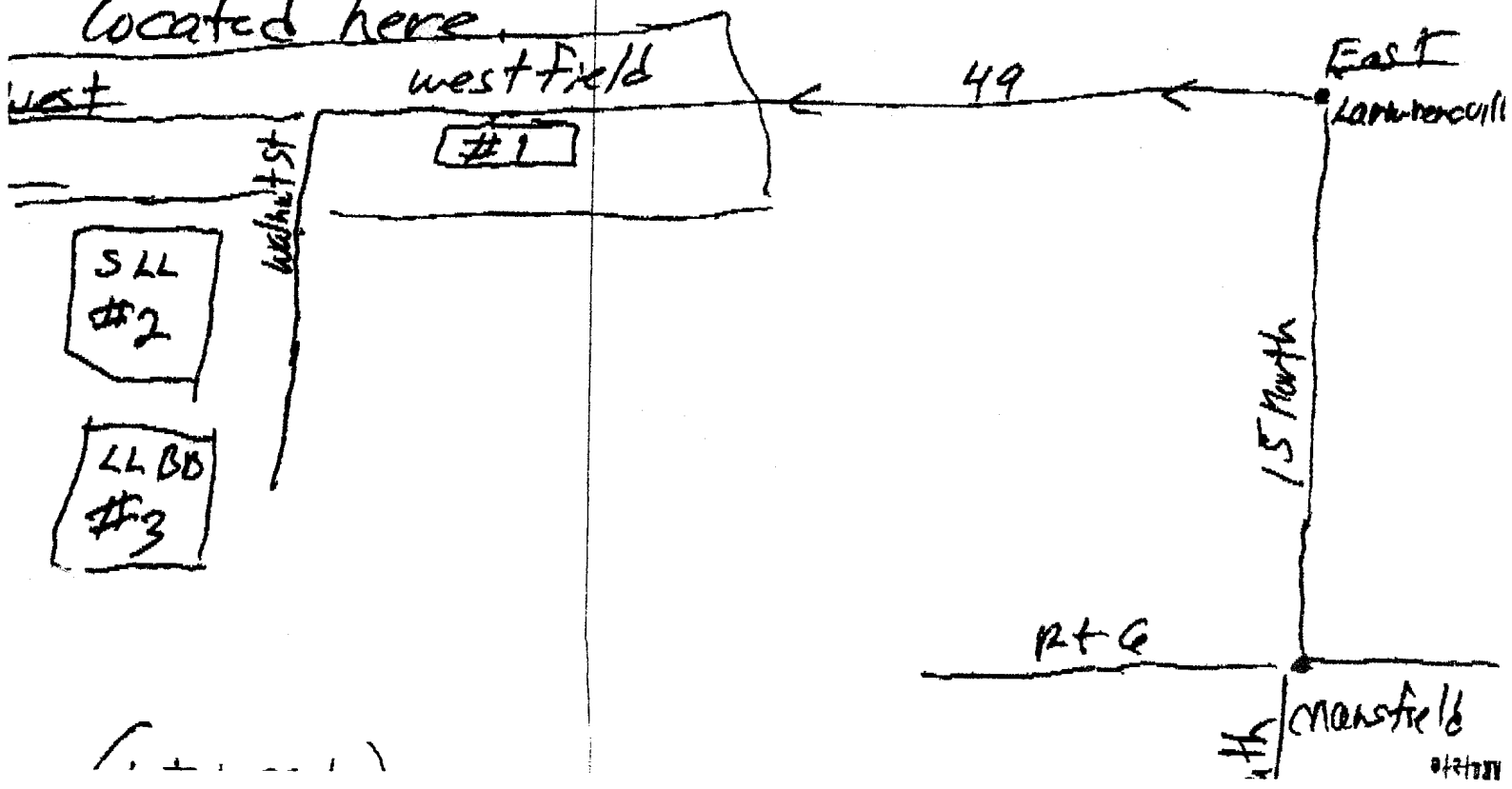

Harrison Valley Little League Field

8

From Rt 6 West in Mansfield, turn right onto 15 North and Travel to Lawrenceville. At Light in Lawrenceville turn left onto Rt 49 west. Go through Elkland, Knowville & Westfield and proceed on 49 west to small community of Harrison Valley. 49 west makes a sharp 90° turn ~~left~~ in middle of town. Proceed approx 1/4 mile past sharp turn and field is clearly visible on right within 30 yards of Rte 49.

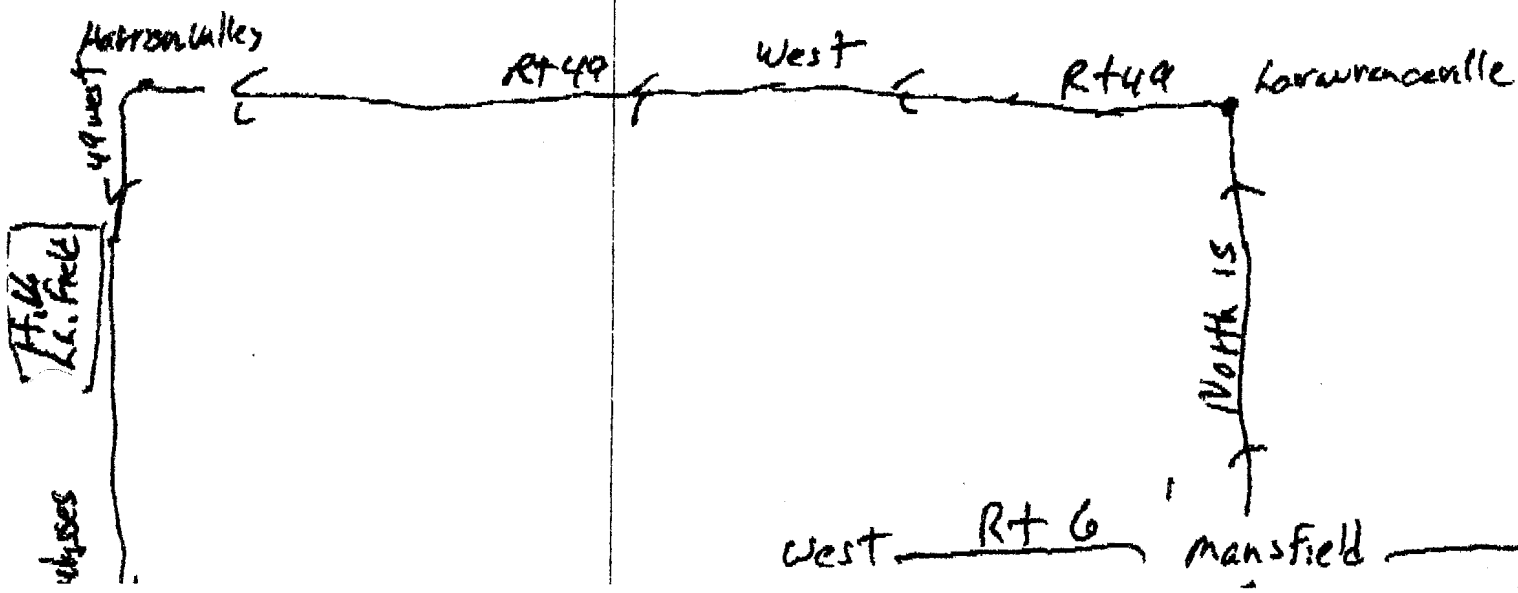

Ulysses Senior Little League Baseball Field

From Rt 6 West in Mansfield, Turn right onto 15 North to Lawrenceville. At light in Lawrenceville turn left onto 49 West. Go through Elkland, Knoxville Westfield & Harrison Valley. The ball field is approx. 13 miles from Westfield, 1 mile east of town of Ulysses. On top of hill on right side is Northern Potter High School. Field is behind school.

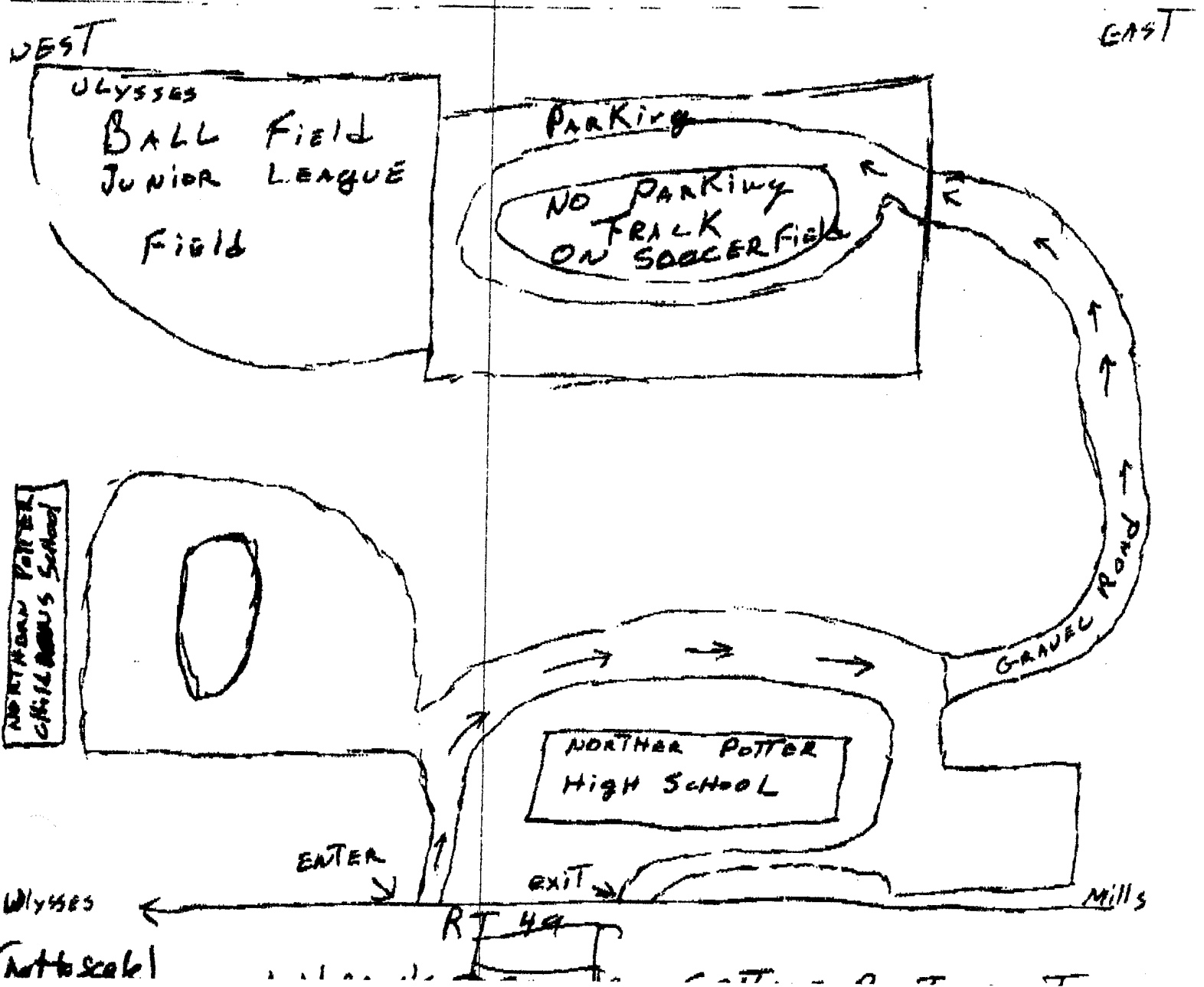

Ulysses Little League Field

(10)

From Rt 6 West in Mansfield, Turn right onto Rt 15 North to Lawrenceville. At light in Lawrenceville turn left onto Rt 49 West. Go through Elkland, Knoxville, Westfield + Harrison Valley. Ulysses is approximately 14 miles from Westfield. As you come down hill into Ulysses main st will be straight ahead while Rt 49 West turns right. Proceed straight ahead on main street 1 full block, 2 churches at intersection, you will turn left from main street onto Academy st here. Proceed a very short distance approx. 50 yards - turn left. Follow this road around behind Apartment Building to Field behind.

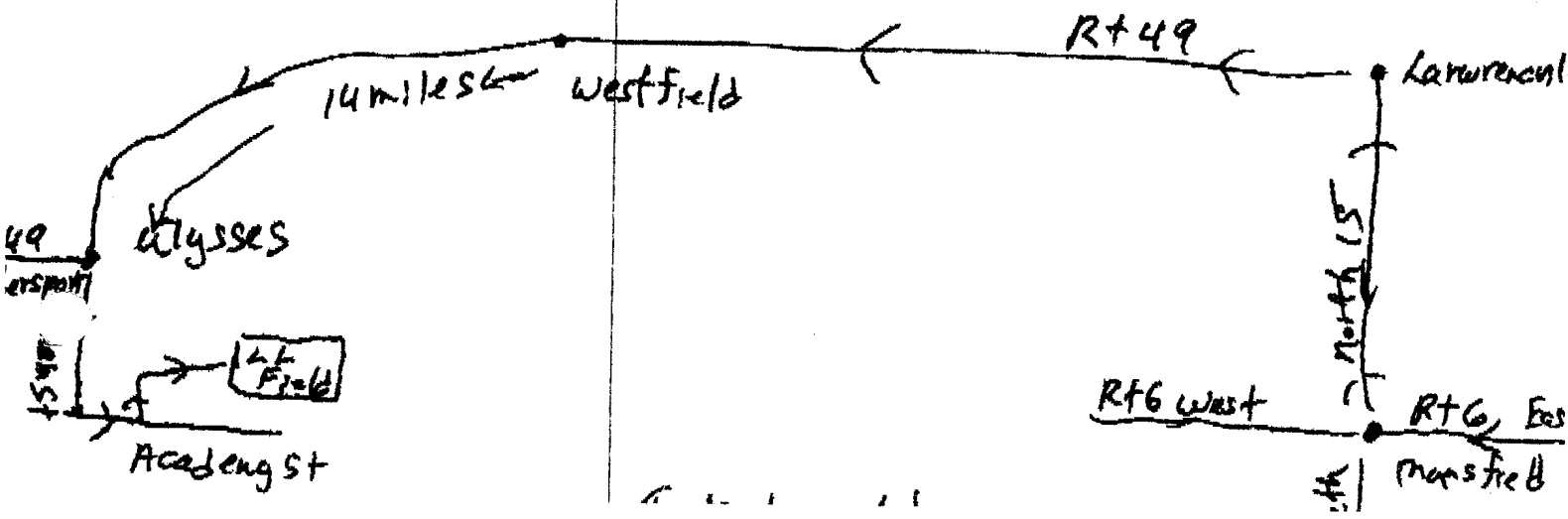

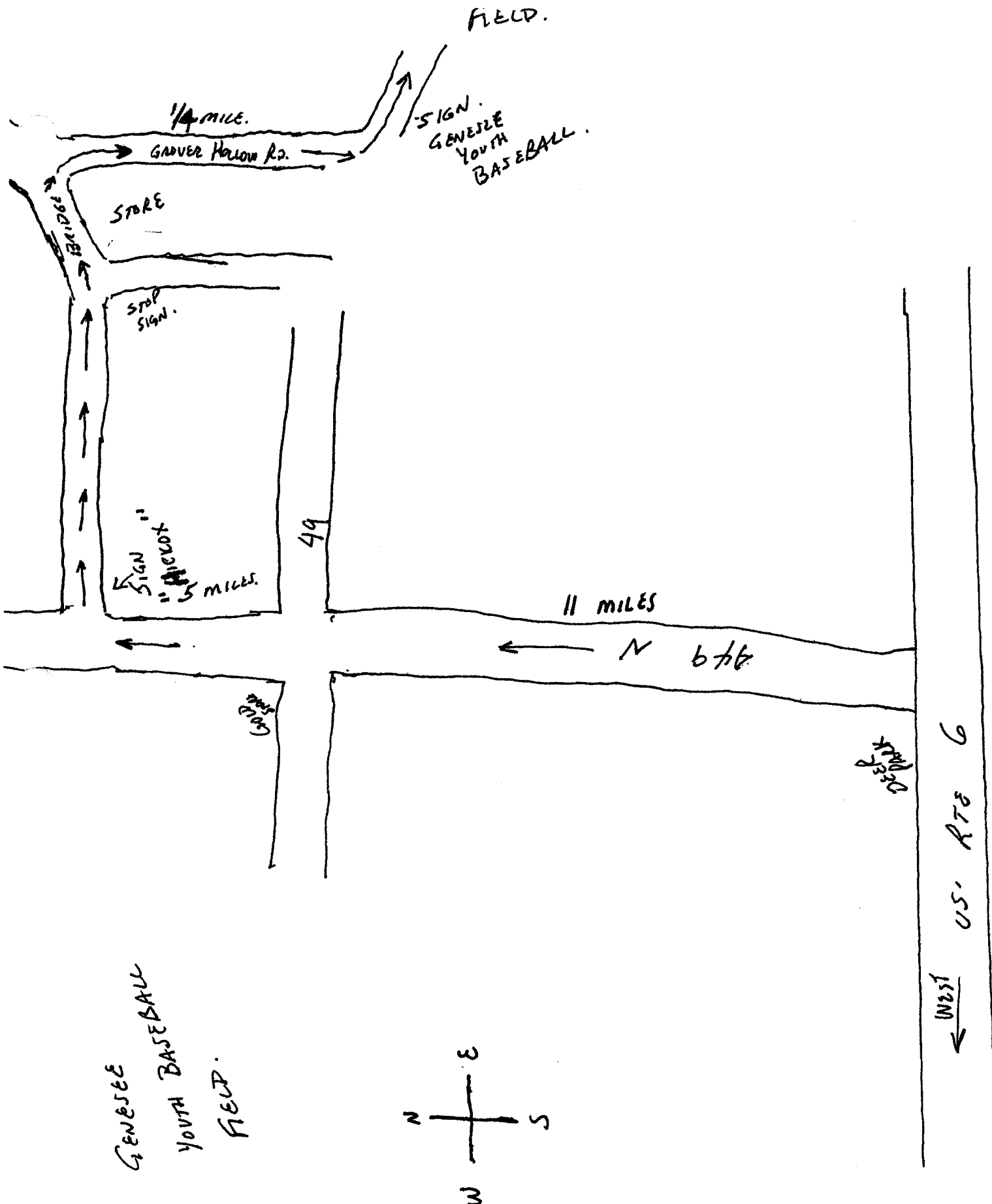

GENESEEE
YOUTH BASEBALL
FIELD.

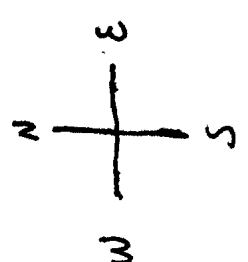

WEST
US. RTE 6